

## INSTRUCTION MANUAL

### 1. Description and range of application

Fully automatic pump for the condensate drain of the gas boiler in cases where gravity drainage is not possible.

### 2. Technical data

Pump:	
Voltage:	230 V ~ 50Hz
Max. power input:	30 W
Max. flow:	12 l/h
Max. head:	19 m
Max. condensation temperature:	60 °C
Protection class:	IP 20
Max. external inlet diameter:	22 mm
Discharge internal diameter:	6 mm
Plug:	Schuko or French-Belgian standard
Power supply:	max. 16 A 250 V
Power cable:	length: 2 m

### 3. Scope of deliver

1. Filter grid
2. Plate with tank and sensor
3. Delivery hose holder
4. Vibration dampers (for wall mounting)
5. Vibration dampers for pump
6. Pump
7. Cover

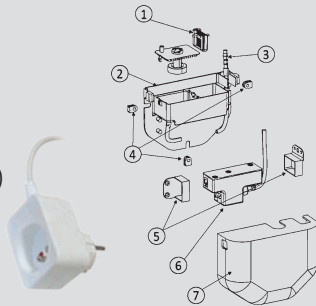

### 4. Installation and start up

**!** **WARNING:** Read instructions completely before installing, operating or servicing the pump! The installation may only be performed by a qualified person. Check content for completeness and eventual damage prior to operation. Inform your dealer immediately in case of any deficiency.

**!** Never move the pump by holding it by the cable!

**!** An earth leakage circuit breaker (breaking current 30 mA) and a grounded mains system is required for pump operation.

### 4.1 Installation and connection

To ensure proper operation, the product should be installed with the supporting wall on a vertical surface in a position below the condensate drain. The system also should be as close as possible to the condensate drain, taking care that the piping does not kink or constrict. Passage through a false ceiling requires additional piping and fittings.

### 4.2 Internal connection and signalling cable

In addition to the electrical connection, the pump must be hydraulically connected with an inlet pipe to the boiler drain and an outlet pipe to the sewer. In case the condensate acidity has a pH lower than what is regulated by the standard, a neutralizing system is required before the condensate relaunch.

**!** For proper shutdown and alarms, follow the boiler manufacturer's instructions.

The wiring diagram is not available because the device is supplied with a cable and plug.

### 4.3 Hydraulic connections

PVC tubing with an inner diameter of 6 mm is to be tightly connected to the pressure port and channel the tube to an appropriate drain avoiding kinking.

In order to prevent siphoning the end of the discharge tube must be higher (+0.5 m) than the water level in the tray of the air conditioning unit.

**!** **WARNING:** Consequence of non-observance may be dry-run or destruction of pump.

### 4.4 Testing

A test startup should be carried out in a professional way after connecting the components so as to ensure that system leakage is excluded. For this purpose, the tank should be filled with clean water until the pump starts, then waiting for automatic shutdown. This operation is to be repeated 2-3 times.

### 5. Limitation of use and improper operation

**!** **WARNING:** This pump cannot be used with dirty water.

Mini condensate pump SMART EASY 2.0 should only be installed indoors and dry (the pump should never work submerged or partially wet).

### 6. Maintenance

**!** **!** **WARNING:** Make sure the system is disconnected from the power supply before any maintenance operation!

The proper operation, wear, and life of the pump depends mainly on its regular maintenance. Dirt particles and sediment can thicken at the bottom of the tank over time, causing malfunctions such as pump clogging or float blockage. Inspection of the tank should be performed at regular intervals. This can be easily done by removing the cover. It is recommended that the tank and piping be inspected every two years and, if necessary, cleaned.

After this operation, rinse with clean water 2-3 times.

**WARNING:** All points described above regarding installation and initial start-up should also be observed after maintenance operations.

### 7. Warranty

The warranty period for this product is 24 months from date of purchase. Proof of purchase must be provided. Any material or manufacturing defect within this timeframe will be rectified or repaired free of cost. Any damage resulting from misuse, in particular non-observance of the instruction manual and excessive wear and tear is excluded from warranty. Any unauthorized modifications or opening of the product will void the warranty.

### 8. Declaration of conformity

This declaration is valid for the following product:  
Device type: Mini condensate pump SMART EASY 2.0

We hereby declare that the product is conformed to the Low Voltage Directive (2006/95/EG).

The following norms have been taken as a reference with respect to the electromagnetic compatibility: 2004/108/EG.

This declaration is made by:  
Steelpumps Srl - Via Sicilia - 56035 Lari (PI)  
Lari, 22/04/2022

Technical Manager: Luca Pinori

